

User's Manual

Wall fixation system for Res-Q-Board



This appliance conforms with the Directive 93/42/CEE "Medical Devices"

Guarantee of Quality system for the production and the final control of the products certified by the notifying body TÜV SÜD Product Service GMBH

INDEX

General Information	page 2	Operating Instructions	page 3
Warnings	page 2	Maintenance and Cleaning	page 4
Description of Product	page 2	Accessories and Spare parts	page 4

Thank you for choosing a Spencer product

1 GENERAL INFORMATION





1.1 AIM AND CONTENTS

The aim of this manual is to supply all the information necessary so that the client, will not only attain adequate use of the appliance, he will also be capable of using the instrument in the most autonomous and secure way possible. This includes information regarding technical aspects, functioning, maintenance, spare parts and safety.

1.2 CONSERVATION OF THE INSTRUCTION MANUAL

The instruction and maintenance manual must be kept with the product, inside the specially provided container and above all, away from any substances or liquids which could compromise perfect legibility.

1.3 SYMBOLS USED

SYMBOL	MEANING
	General or specific warning
	See instructions for use
	Lot number
	Product code
	The product is compliant with the specifications of the Directive 93/42/CEE

1.4 SERVICING REQUESTS

For any information regarding the use, maintenance and installation, please contact the Spencer Customer Care Service on 0039 0521 541111 - fax 0039 0521 541222 - e-mail: info@spencer.it or write to Spencer Italia S.r.l. - Strada Cavi, 7 - 43044 Collecchio (Parma) - ITALY.

1.5 DEMOLITION

Follow the current regulations.

1.6 LABELLING

The serial number as indicated below can be found on each appliance and must not be removed or covered. In order to facilitate assistance please indicate or communicate the lot number (LOT) on the label.

2 WARNINGS

2.1 GENERAL WARNINGS

- Before carrying out any kind of operation on the appliance, the operator must carefully read the enclosed instructions, paying particular attention to the correct safety precautions and to the procedures to be followed for installation and for correct use.
- In the case of any doubts as to the correct interpretation of the instructions, please contact Spencer Italia S.r.l., for any necessary clarifications.
- Regularly check the appliance. Carry out the prescribed maintenance in order to keep the appliance in good condition and to guarantee correct functioning and a long life.
- In the case of any abnormalities or damage to the appliance, which could jeopardize the functioning and the safety, the appliance must be immediately removed from service.
- Do not alter or modify in any way the appliance; any such interference could cause malfunctions and injury to the patient and/or rescuer.
- The appliance must not in any way be tampered with. In such cases all responsibility will be denied for any malfunctions or injuries caused by the appliance itself. Those who modify or have modified, prepare or have prepared medical appliances in such a way that they no longer serve the purpose for which they were intended, or no longer supply the intended service, must satisfy the valid conditions for the introduction onto the market.
- Ensure that all the necessary precautions are taken in order to avoid the hazards that can arise as the result of contact with blood or body fluids.
- Handle with care.

2.2 SPECIFIC WARNINGS

- The product must be used by trained personnel only.
- Avoid putting excessive pressure onto the device when using: excessive pressure could cause damage or have a negative influence on the functioning.
- Use the device only as described in this instruction and maintenance manual.
- Do not alter or change the item in anyway to adapt it to the emergency vehicle. This could cause damage to the structure and cause unexpected problems, structural damage and would cause the loss of the product warranty.

2.3 CONTRAINDICATIONS AND SIDE EFFECTS

The use of this device, if used as described in this manual, does not present any contra-indications or collateral effects.

3 DESCRIPTION OF PRODUCT

3.1 INTENDED USE

The Res-Q-Board wall support is a blocking system which permits a safe and efficient fixture to the wall of the board for CPR manoeuvres.

3.2 MAIN COMPONENTS

1. Base in aluminium for wall support
2. Pin for blocking
3. Blocking lever in red nylon
4. Upper closure lever

3.3 MODELS

RB70010A Wall fixation system for Res-Q-Board

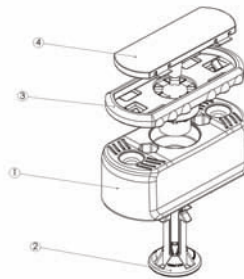

Fig. A

3.4 TECHNICAL DATA

Length	80 mm
Width	38 mm
Height	38 mm
Weight	70 g
Material of the structure	Aluminium
Material of the lever	Nylon

3.5 ENVIRONMENTAL CONDITIONS

Functioning temperature: from -20 to +60 °C
Storage temperature: from -20 to +60 °C
Relative humidity: from 5 to 85%

4 OPERATING INSTRUCTIONS

4.1 TRANSPORT AND STORAGE

Before transporting the appliance, make sure that it is correctly packaged ensuring also that there are no risks of shocks, bumps or falls during the transport itself. Keep the original packaging for use in case of any further transport. Damage to the appliance caused during transport and handling is not covered by the guarantee. Repairs or replacement of the damaged parts are the responsibility of the client. The appliance must be stored in a dry place free from humidity.

4.2 PREPARATION

On receipt of the product:

- Remove the packaging and display the material so that all components are visible.
 - Check that all the components/pieces on the accompanying list are present.
- The appliance must be checked before every use so as to reveal any working abnormalities and/or damage caused by transport and/or storage.
- Before each use:
- On the removal from the plastic packaging check that all parts are present and none are in anyway damaged.
 - Make sure that the red lever moves properly.
- If all is in correct working order, the device is ready to be used. If any additional information is required please contact the Spencer Customer service (paragraph 1.4).
- If in anyway the support does not appear to be in correct working order, it must be immediately removed from service and contact the Spencer Customer Service.

4.3 REQUIREMENTS OF INSTALLATION SURFACE

The wall support for Res-Q-Board has been designed for installation in the sanitary compartment of the ambulance or on any surface of a building where a CPR board could be required. The installation surface must have the following:

- A flat surface.
- The attachment area must be an area sufficiently sized to easily house the dimensions of the resuscitation board without the presence of any obstructions.

4.4 FUNCTIONING

4.4.1 FIXING THE SUPPORT TO THE WALL

1. Position the hook on the wall to which the device will be fixed.
2. Place the support with the base against the surface making sure there is nothing creating an obstacle to the device.
3. Use the device as a die for the holes and using TPSEI M6 resistance class 10.9 screw it into position placing the plate on the other side and fixing with automatic blocking M6 nuts.

4.4.2 BLOCKING THE RESUSCITATION BOARD ON THE WALL

1. Position the device on the fixing surface with the concave area of the Res-Q-Board pointing downwards.
2. The handle which is now at the top of the board will fit into the wall support.
3. Turn the red lever 90° (n° 3 fig. A) until it is in the vertical position (fig. B).

4.4.3 REMOVING THE RESUSCITATION BOARD FROM THE WALL

1. Move the red lever (n° 3 fig. A) to the horizontal position.
2. Slide the board out of the support. It is immediately now ready for use.

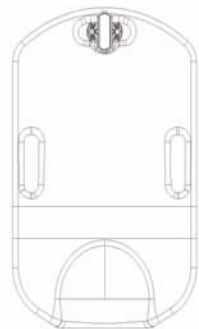

Fig. B

4.5 TROUBLESHOOTING

PROBLEM	CAUSE	REMEDY
The red lever does not turn	The pivot inside is blocked	Immediately remove the device from use and contact the service centre
Structural damage	Improper use	Immediately remove the device from use and contact the service centre

5 MAINTENANCE AND CLEANING

5.1 CLEANING

The exposed metal parts are usually treated and/or painted in order to increase their resistance. Clean the exposed parts with water and delicate soap, then dry with a soft cloth. In order to obtain a shine effect, it is possible to use car waxes and creams. Do not clean with high pressure water; this will damage the joints and the lubricated parts.

If the fixation system is not cleaned regularly, this may cause risks in terms of cross-contamination. We also recommend the use of the polishing detergent Spencer STX 99 (code ST50000E) on the metallic and not metallic parts.

5.2 MAINTENANCE

5.2.1 Precautionary Maintenance

The person who carries out the precautionary maintenance of the appliance (user in person, manufacturer/supplier or a third party) has to guarantee the following basic requirements:

- Technical knowledge of the appliance and of the periodic maintenance procedures as described in these instructions.
- Specific qualifications and training in the maintenance operations of the appliance in question.
- The use of components/replacement parts/accessories that are either original or approved by the supplier, in such a way that each operation causes no alteration or modification to the appliance.
- Possession of the checklist of operations carried out on the appliance.
- Guarantee complete adherence to the instructions of the Directive 93/42/CEE which includes also the obligation towards the manufacturer to maintain post sales records and traceability of the appliance if requested.

A planned and correctly executed maintenance increases the durability of the fixation system. It is necessary to create a plan for maintenance and periodic check-up, assigning a person to this job.

Controls to be performed before every operation:

- Functionality of the device
- State of use (moving parts)

All maintenance which not include lubrication, fixation of nuts and bolts, ordinary cleaning, must be performed by Spencer Italia S.r.l. or an authorized Spencer Service Centre



The device does not require any routine servicing by the manufacturer.

5.2.2 Special servicing



Only the manufacturer or centres with written authorisation are authorised to complete any special servicing operations.

6 ACCESSORIES AND SPARE PARTS

There are no accessories or replacement parts for this item.

Warning

The information contained in this document could be modified without any warning and is not to be intended as a commitment on behalf of Spencer Italia S.r.l. Spencer products are exported to many countries and the same identical regulations are not always valid. For this reason there could be differences between the description here described and the product actually delivered. Spencer continually strives to reach the perfection of all items sold. We therefore hope you will understand if we reserve the right, at any time, to modify the shape, equipment, lay-out or technical aspects that are herein described.

© Copyright Spencer Italia S.r.l.

All rights reserved. No part of this document can be photocopied, reproduced or translated into another language without the written approval of Spencer Italia S.r.l.